

THREE BEDROOM

TYPE U1

horizon home



560
LONSDALE ST

MELBOURNE
GRAND



130m²

TYPE U1 *horizon home*



3



2



1 + store

Large Relaxing Balcony

Spacious floorplan with stunning views set high up on the 51st floor, featuring a bright and spacious design with large kitchen.



LIVING ROOM ARTIST IMPRESSION WITH OPTIONAL STUDY

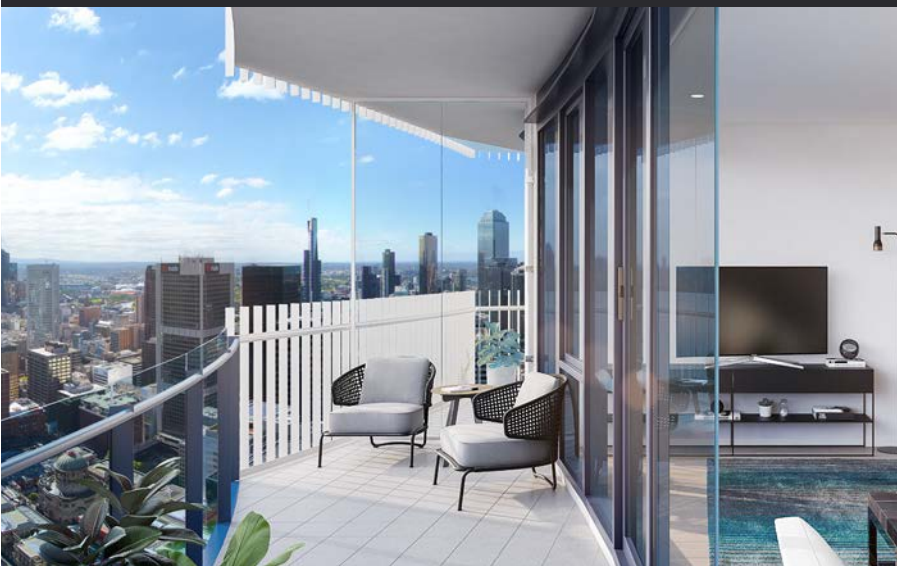

horizon home inclusions

- Timber flooring to living area
- Motorised sheer blinds plus blockout blinds to bedrooms
- Integrated Fisher & Paykel dishwasher drawer
- Integrated Miele microwave
- Miele washer & dryer upgrade





An entire floor of facilities, including a spacious lounge, formal banquet room, luxe theatre, coffee bar, indoor pool, sauna, gym, yoga studio, BBQs and outdoor relaxation areas. An impressive grand foyer is complemented by concierge services, keyless building entry and video intercoms.

EXCLUSIVE RESIDENT FACILITIES



**MELBOURNE
GRAND**

MelbourneGrand.com

+613 9278 8888 • 1800 638 888

INSPECT 7 DAYS

560 Lonsdale Street, Melbourne

For sale off-the-plan. Artist impressions are for indicative purposes only and advertised prices may be of a different design and/or view.
© Copyright September 2017. Central Equity Limited.